

ELECTRICAL DEVICES	
⊕	SWITCH
⊕ ₃	THREE WAY SWITCH
⊕	DUPLEX OUTLET
⊕	OUTLET ABOVE COUNTER
⊕ GFI	OUTLET ABOVE COUNTER GFI
⊕ WP GFI	WEATHERPROOF GFI OUTLET
⊕	220 OUTLET
⊕	DISCONNECT
▶	TELEPHONE & DATA JACK
▶	TELEPHONE JACK
▽	TELEVISION JACK
⊕	COMBINATION CO. & SMOKE DETECTOR, 120V & 9V BATTERY KIDDE #900-0114E, INTERCONNECTED
—	INCANDESCENT ROPE LIGHT STRIP
⊕	EXHAUST FAN
⊕	SURFACE MOUNTED CEILING LIGHT
⊕	INCANDESCENT HANGING LIGHT
⊕	BRACKET MOUNTED LIGHT
⊕	RECESSED LIGHT FIXTURE SMALL
⊕	RECESSED LIGHT FIXTURE
⊕	SURFACE LIGHT FIXTURE SMALL
⊕	RECESSED DIRECTIONAL LIGHT FIXTURE SMALL
⊕	CEILING MOUNT FLORESCENT FIXTURE
⊕	CEILING MOUNTED FAN WITH LIGHT
⊕	MOTION SENSITIVE FLOOD LIGHTS
⊕	RECESSED ELECTRICAL PANEL
⊕	JUNCTION BOX
⊕	WIRING CONTINUES ON OTHER FLOOR
⊕	HOMERUN BACK TO ELECTRICAL PANEL
⊕	JUNCTION BOX

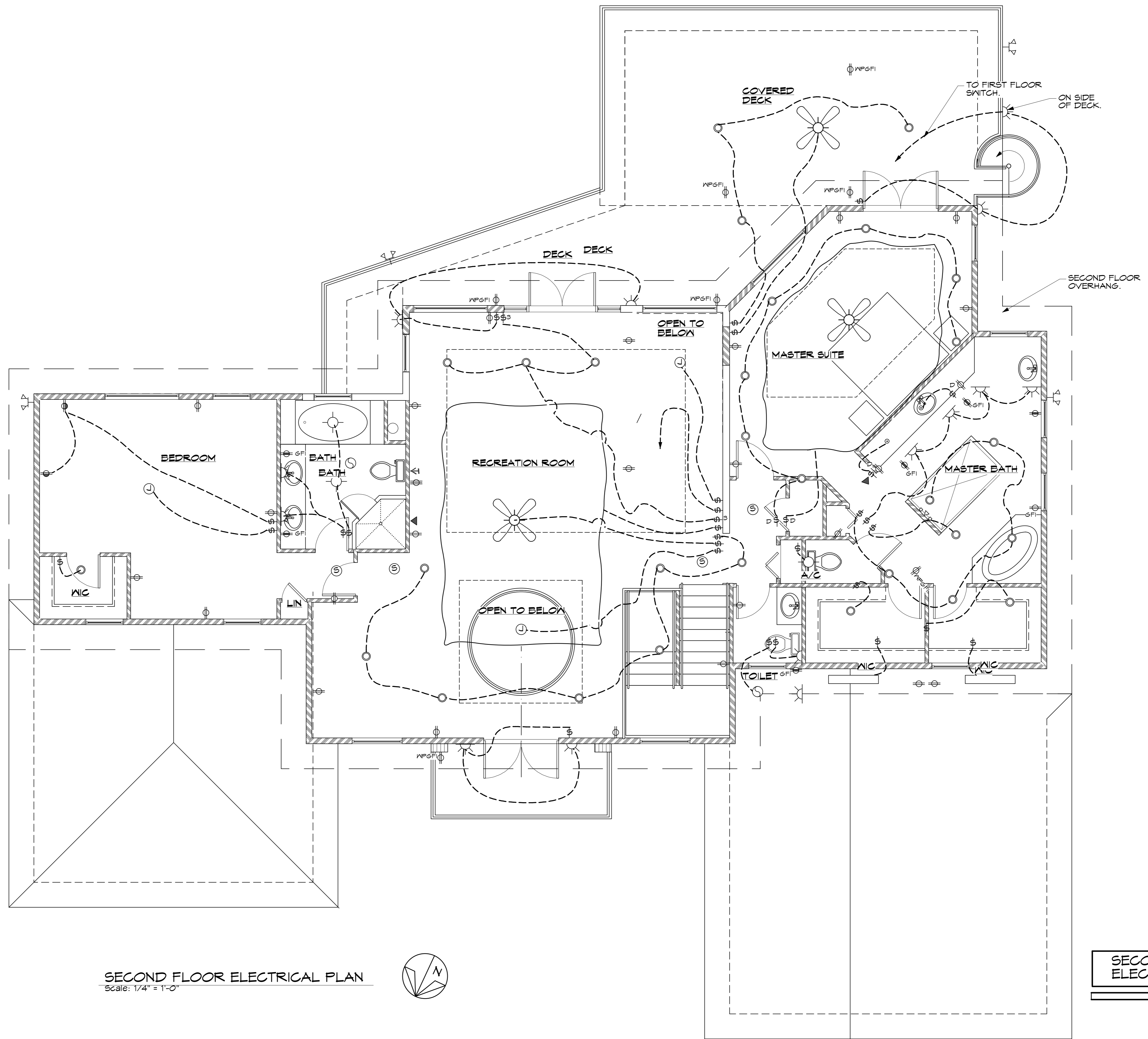

SECOND FLOOR ELECTRICAL PLAN

Scale: 1/4" = 1'-0"



SECOND FLOOR
 ELECTRICAL PLAN