

ELECTRICAL DEVICES	
⊕	SWITCH
⊕ ₃	THREE WAY SWITCH
⊕ _{3D}	THREE WAY SWITCH
⊕ _D	DIMMER SWITCH
⊕	DUPLEX OUTLET
⊕	OUTLET ABOVE COUNTER
⊕ _{GFI}	OUTLET ABOVE COUNTER GFI
⊕ _{WPGFI}	WEATHERPROOF GFI OUTLET
⊕	220 OUTLET
⊔	DISCONNECT
▶	TELEPHONE & DATA JACK
▶	TELEPHONE JACK
▼	TELEVISION JACK
Ⓟ	DOORBELL PUSH BUTTON
Ⓞ	DOORBELL CHIME
Ⓢ	COMBINATION CO & SMOKE DETECTOR, 120V & 9V BATTERY KIDDE #900-0114E, INTERCONNECTED
⊙	SURFACE MOUNTED CEILING LIGHT
⊙	POST MOUNTED INCANDESCENT LIGHT
⊙	BRACKET MOUNTED LIGHT
⊙	RECESSED LIGHT FIXTURE SMALL
⊙	RECESSED LIGHT FIXTURE
⊙	CEILING MOUNTED FAN WITH LIGHT
⊕	MOTION SENSITIVE FLOOD LIGHTS
⊔	RECESSED ELECTRICAL PANEL
⊔	GARBAGE DISPOSAL
⊔	WIRING CONTINUES ON OTHER FLOOR

ELECTRICAL PLAN NOTES:

- CONTRACTOR SHALL VISIT THE SITE AND FAMILIARIZE HIMSELF WITH EXISTING CONDITIONS PRIOR TO SUBMITTING A PROPOSAL.
- ALL WORK SHALL BE IN ACCORDANCE WITH THE LATEST EDITION OF THE NATIONAL ELECTRIC CODE.
- ALL CONDUCTORS SHALL BE COPPER #12 MINIMUM.
- ALL CONDUITS SHALL HAVE A PROPERLY SIZED EQUIPMENT GROUNDING CONDUCTOR.
- PROVIDE ALL NECESSARY PULL/JUNCTION BOXES, SUPPORT AND MISC. ITEMS FOR A COMPLETE INSTALLATION.
- PROPERLY SEAL ALL PENETRATIONS OF FIRE RATED CONSTRUCTION AREAS.
- PROVIDE TYPE WRITTEN PANEL DIRECTORIES.
- ALL WIRING SHALL BE IN A CONTINUOUS CONDUIT SYSTEM.
- BRANCH CIRCUIT WIRING MAY BE IN TYPE NM-B (ROMEX).
- ELECTRICAL WORK SHALL BE COORDINATED WITH ALL OTHER TRADES.
- SWITCHES AND RECEPTACLES SHALL BE 20 AMP COMMERCIAL GRADE AND IVORY IN COLOR, PROVIDE MATCHING PLATES.
- CONCEAL ALL CONDUITS AND BOXES UNLESS OTHERWISE NOTED.
- COORDINATE ALL POWER REQUIREMENTS WITH LOCAL POWER COMPANY ENGINEER.
- PROVIDE AND MAINTAIN TEMPORARY POWER AND LIGHTING SYSTEM FOR DURATION OF THE PROJECT.
- EMT FITTINGS SHALL BE DIE CAST SET SCREW.
- MAKE FINAL CONNECTIONS TO EQUIPMENT WITH FLEXIBLE METAL CONDUIT, LIQUID TIGHT WHERE EXPOSED TO WEATHER.
- USE EXISTING OUTLETS WHERE POSSIBLE.
- ALL EXPOSED WIRING TO BE IN WIRE MOLD CONDUIT OR APPROVED EQUAL.
- CONNECT NEW CIRCUITS TO EXISTING 200 AMP PANEL.

NOTE:
CONTRACTOR SHALL VERIFY EXISTING, OR IF NOT INSTALL, APPROVED INTERCONNECTED COMBINATION CO AND SMOKE DETECTOR INSIDE EACH BEDROOM AND WITHIN 10' OUTSIDE OF BEDROOM DOORS.

NOTE:
ALL NEW & EXISTING LIGHTS & RECEPTACLES IN BEDROOMS ARE TO USE ARC-FAULT BREAKERS

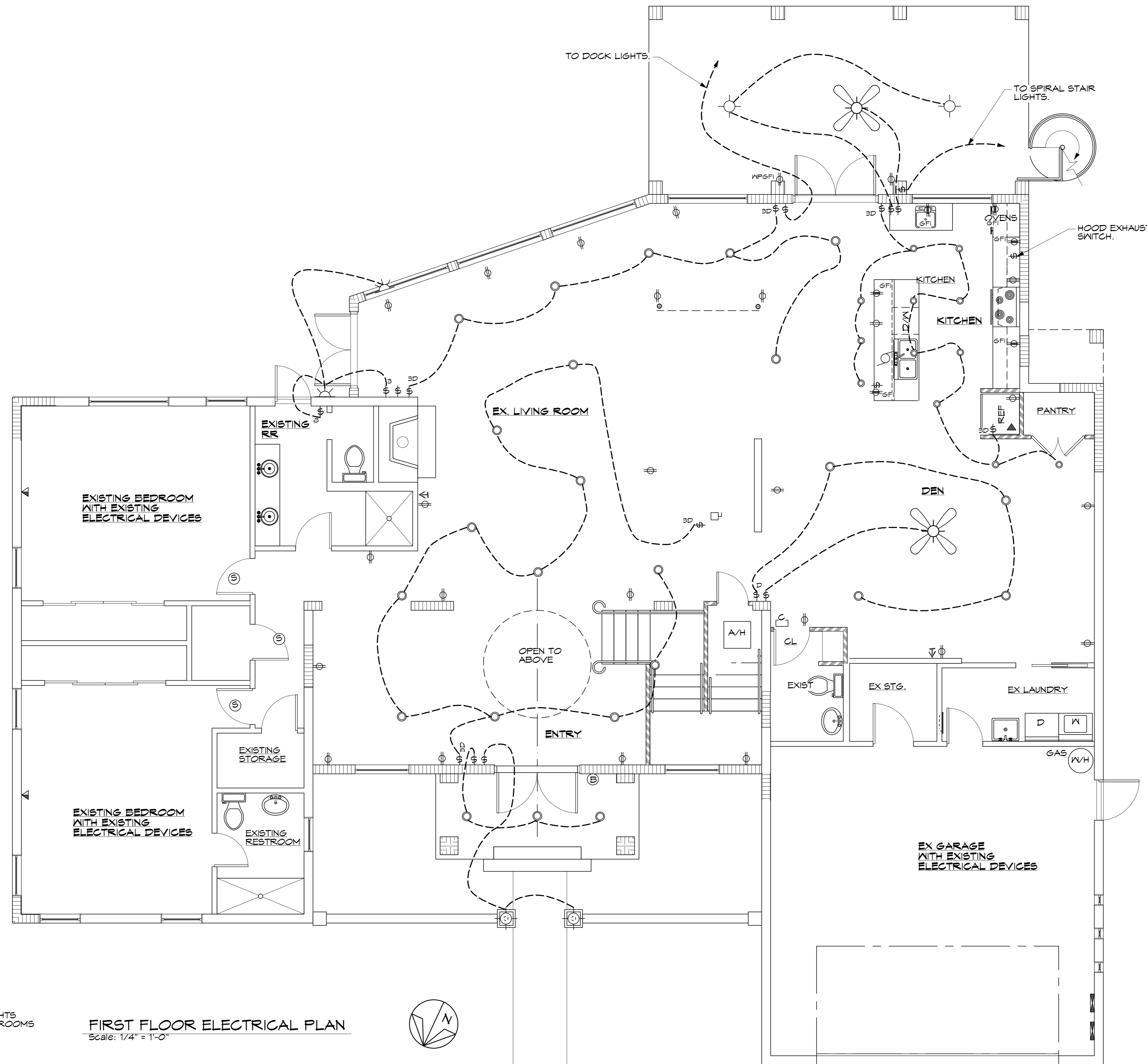

FIRST FLOOR ELECTRICAL PLAN
Scale: 1/4" = 1'-0"

FIRST FLOOR ELECTRICAL PLAN